

What's in the box:

- 1 x Power Stem
- 1 x Add-on compatible Stem Cap
- 1 x USB Cap
- 1 x 2M Charging Cable
- 1 x Lightning Device Cable
- 1 x USB-C Device Cable
- 1 x Micro USB Device Cable
- 1 x Mini USB Device Cable
- 2 x M4 Steerer Tube Mounting Screws
- 4 x M4 Stem Cap Mounting Screws

Key Features:

- ① Power Button
- ② USB Port
- ③ Mini USB Port

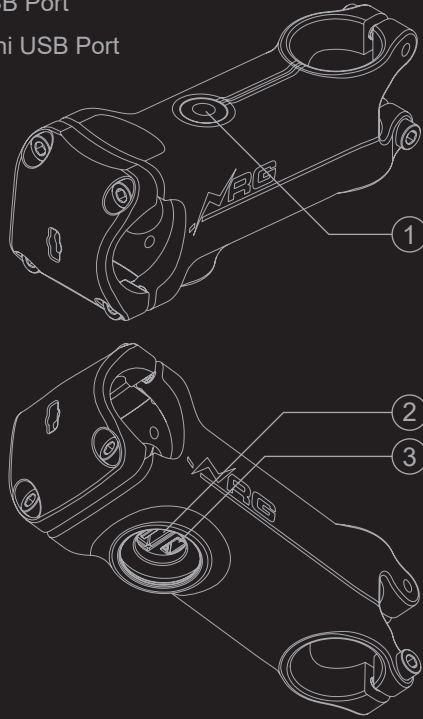

1. Product Safety

1.1: Installation:

- NRG recommend professional installation only.
- Only use a torque wrench to tighten the screws carefully. Follow the torque numbers shown on the stem and in the instructions.

1.2: Before ride checklist:

- Ensure the forks rotate without any play in the steering column.
- Make sure the handlebars do not rotate or move in the Power Stem.
- Check for any damage on the Power Stem, such as cracks or corrosion. Do not use bike if Power Stem shows any of these signs.

1.3: The Power stem is designed for both on and off road use, however it is not intended for use under competitive or race conditions, jumping or stunts.

2. Installation

2.1: Before you start:

- The Power Stem is only intended for 28.6mm steerer tubes. The steerer must be cleanly cut and level with no burrs.

Installation:

2.2: Remove any dirt and grease from the Power Stem and handlebar clamp areas.

2.3: It is recommended to apply a small amount of grease to the threads on the screws before assembly to avoid corrosion. If you are using titanium bolts, it is also recommended to use copper slip grease or Ti-prep to avoid seizing.

2.4: Undo the steerer tube screws on the Power Stem, and then with the Power Button facing up, push the Power Stem onto the steerer tube as far as it will go. The gap between the top of the Power Stem and the top of the steerer tube should be approximately 3-5mm (Fig 02). If the gap is more than this, remove the Power Stem and place spacers onto the steerer tube. Add or remove spacers until the gap is 3-5mm. Do not place spacers on top of the Power Stem.

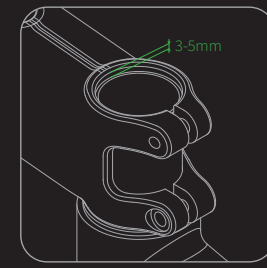

2.5: Install the top cap and compression bolt to the top of the Power Stem, as per the manufacturers specifications. This is typically until all the play is removed, yet the Power Stem can still smoothly rotate.

2.6: Insert the steerer tube mount screws into the Power Stem and loosely tighten (Fig 03). Line up the Power Stem orientation by making sure it is in line with the front wheel. Once you are satisfied it is aligned, tighten the screws. Use a torque wrench to tighten the screws to 5Nm - do not over tighten. Note: Loosely tighten the handlebars into the Power Stem to help alignment.

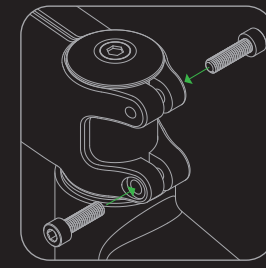

2.7: Install the handlebars into the Power Stem, making sure the Stem Cap is orientated correctly. (Fig 04) Insert all 4 screws into the Power Stem and (Fig 05) loosely tighten them, then line up the handlebars. When you are satisfied the handlebars are aligned, start tightening the screws in the sequence shown in 'Fig 06'. Use a torque wrench to tighten the screws to 5Nm.

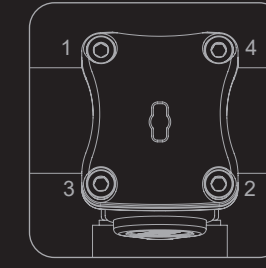
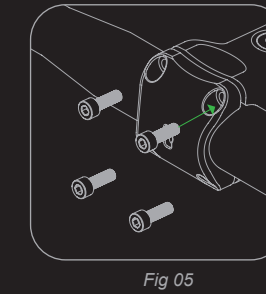
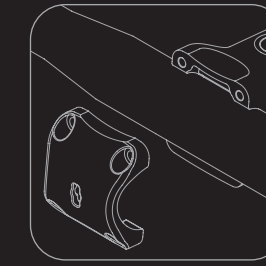

3. Safety and Maintenance

3.1: Break in Period

After a break-in period of around 150 km, after first fitting, check all the hardware is still tight, using a torque wrench set to the specified torque.

3.2: Regular maintenance

- Regularly check all hardware is tight, at least every 1500km.
- Inspect for any damage before each ride.
- Periodically regrease all hardware
- In the event of an impact or drop, check for damage to the Power Stem.

3.3: When cleaning the Power Stem, it is recommended to use a damp cloth, DO NOT jet wash.

4. Using the Power Stem

4.1: While the charging function is not in use, always ensure the USB cap is in the Power Stem.

4.2: Use the custom cables with seals to charge devices, plugging the cables into the USB Port.

4.3: When a device is plugged in, press the Power Button once to turn on the Power Stem.

4.4: Repeatedly press the Power Button to change the brightness of the LED to suit riding conditions.

4.5: Battery Levels: (Different devices will decrease battery level at different rates due to the power drawer of your device.)

Green - High
Amber - Middle
Red - Low
Flashing Red - Very Low
Flashing Blue - Charging (Turns Green once fully charged)

4.6: The Power Stem will turn off on it's own after a short period of no use.

4.7: Use the supplied 2m charging cable to recharge the Power stem via the Mini USB port. Do not use third party cables.

4.8: Use the bayonet on the front of the Power Stem to attach the cable tidy clip. This will keep excess cable away from your front wheel while in use.

DESIGNED IN THE
UNITED KINGDOM



WWW.NRGSTEMS.COM
NRGSTEMS@OUTLOOK.COM
TRADEMARK: 00003237631
PATENT: 0
DESIGN REGISTRATION: 6027924
COMPANY NUMBER: 10823017



USER MANUAL